

## Installation dimensions

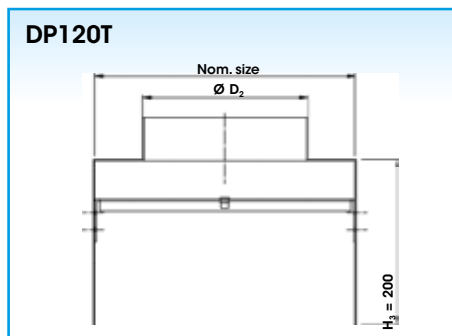
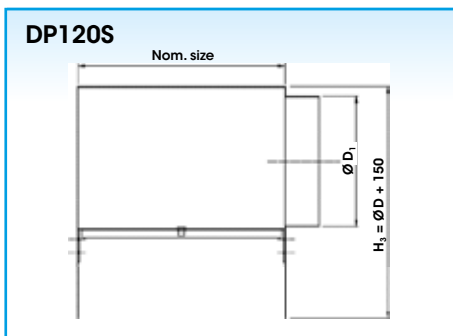
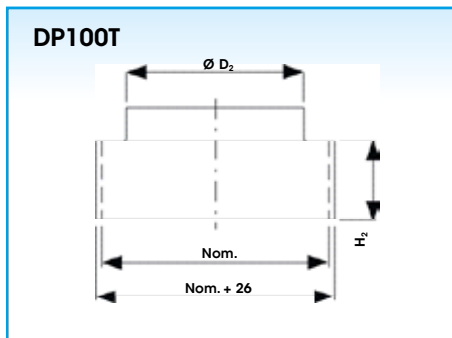
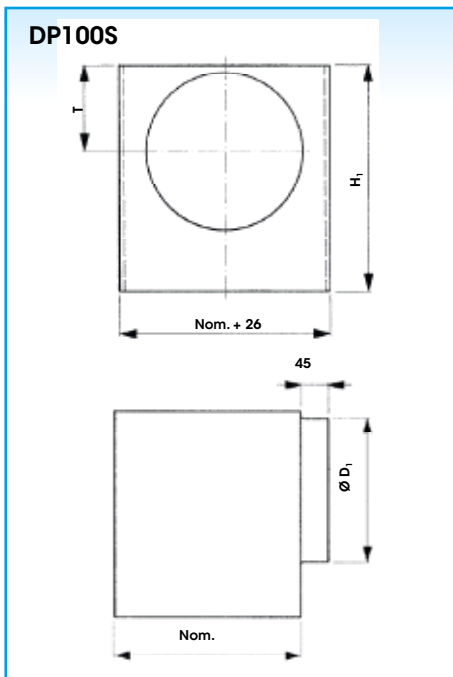

All dimensions in mm

## How to order

DP100 with side entry and damper, insulated, for a diffuser with nominal dimensions 300 x 300 mm

D	P	1	0	0	P	G	D	0	2	0	0	0	5	9	4
								Nom. diameter			size (mm)				

-: without damper  
D: with damper

- : non insulated plenum  
G: insulated plenum

0 zonder montagebeugel voor centrale schroefbevestiging  
2 met montagebeugel voor centrale schroefbevestiging

## PLENUM BOX DP100S • DP100T

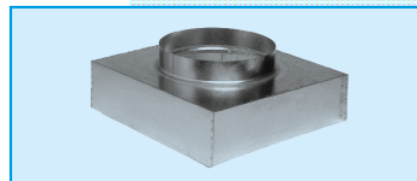
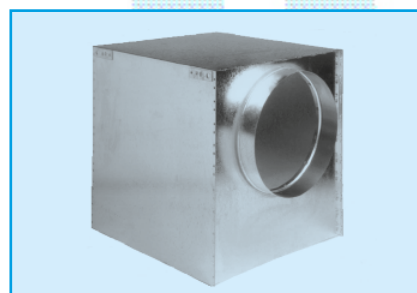

## Application

The plenum box DP100 is used for installation with square or rectangular diffusers and grilles. Both fixed mounting and central screw fixing possible. For an even air pattern through the diffuser, the plenum can be equipped with a perforated diffuser plate. Flow control is possible because of a perforated damper in the inlet spigot of the plenum.

The plenum can be delivered with side or top entry, insulated plenum boxes can be supplied if required.

## Technical information

### Characteristics

- square or rectangular
- fixed mounting on the diffuser or supplied with a mounting support for central screw fixing (only DP100S)
- circular side or top entry
- perforated damper in inlet spigot possible
- internal perforated air diffusion sheet available; only DP100S
- provided with mounting eyes (Ø 7 mm), mounting straps available up-on request
- plenum can be internally insulated
- other dimensions available

### Construction

Galvanised steel sheet with PVC inlet spigot 80, 125, 160, 200 and 250 mm

## Specifications description

### Example:

Insulated plenum box with side entry, supplied with damper and perforated plate for an optimal air pattern. The plenum is supplied with a mounting support for central screw fixing and can be mounted with mounting straps.

**Type: DP131SG**  
Dim. ... x ... mm

## Delivery possibilities

- **DP100S/DP100T:** plenum box for fixed mounting on diffusers or grilles
- **DP101S/DP101T:** DP100S/DP100T with damper in the inlet spigot
- **DP110S:** DP100S with perforated diffuser plate
- **DP111S:** DP100S with damper and perforated plate
- **DP120S:** plenum box with mounting support for central screw fixing
- **DP121S:** DP120S with damper in the inlet spigot
- **DP130S:** DP120S with perforated plate
- **DP131S:** DP120S with damper and perforated plate
- **DP1.SG/DP100TG/DP101TG:** internal insulated plenum box

### Square plenum box with side or top entry

Nom.	ØD <sub>1</sub> · ØD <sub>2</sub>	H <sub>1</sub>	H <sub>2</sub> (1)	H <sub>3</sub>
150	125	225	100	295
200	160	260	130	-
225	200	300	150	370
250	200	300	150	-
300	200	300	150	370
350	250	350	175	-
375	315	415	210	485
400	315	415	210	-
450	315	415	210	485
500	355	455	230	-
525	400	500	250	-
600	400	500	250	-

(1): dimension H<sub>2</sub> with damper  
without damper, height H<sub>2</sub> = 100 mm

All dimensions in mm

### Rectangular plenum box with side entry

Nom.	ØD <sub>1</sub>	T	H <sub>1</sub>
200 x 100	80	55	230
250 x 100	100	65	250
250 x 150	125	77	275
300 x 100	100	65	250
300 x 150	125	77	275
300 x 200	160	95	300
400 x 100	125	77	275
400 x 150	160	95	300
400 x 200	200	115	350
500 x 100	160	95	300
500 x 150	200	115	350
500 x 200	250	140	400
500 x 300	315	172	450
600 x 100	160	95	300
600 x 150	200	115	350
600 x 200	250	140	400
600 x 300	355	192	500
800 x 75	160	95	300
800 x 100	200	115	350
800 x 150	250	140	400
800 x 200	315	172	450
800 x 300	400	215	550
1000 x 75	200	115	350
1000 x 100	250	140	400
1000 x 150	315	172	450
1000 x 200	355	192	500
1000 x 300	400	215	550
1000 x 600	500	265	650
1500 x 150	400	215	550
1500 x 200	400	215	550